

# Model CN001 Bootstrap Compressor

## Increase Shop Air Pressure

**2:1 Maximum Pressure Boost Ratio**

**230 psi Maximum Discharge Pressure**



The Bootstrap Compressor is an air-driven, air pressure booster. It requires no electricity, cooling water, or air-line lubricator and is explosionproof. Shop air is fed to the inlet port through a filter, and is split into two streams inside the booster. One stream flows to the compressor portion of the unit and is boosted to higher pressure. The other stream drives the compressor portion, and is consumed during booster operation. The drive air stream is regulated to maintain the discharge pressure set by the external regulator handle. Drive air consumption is approximately 1/2 to 1 times the amount of pressure-boosted air. For example, if 10 scfm of high pressure air is required, the Bootstrap Compressor will need 15-20 scfm of shop air, and 5-10 scfm of that air will be vented through an exhaust silencer. For a given shop air pressure, Model CN001 can deliver high pressure air at any flowrate up to the maximum shown in the table. The pressure regulator enables the booster to adjust automatically to changes in high pressure air demand or shop air pressure. When there is no demand for high pressure air, the booster stalls at the discharge pressure set by the regulator and consumes no energy. When there is a need for high pressure air, the tank pressure drops which causes the booster to restart automatically.

Supply Pressure psi	Maximum Flowrate scfm	Discharge Pressure psi
50	13	50-95
60	15	60-110
70	20	70-130
80	25	80-150
90	35	90-150
100	40	100-180
110	50	110-200
120	65	120-200

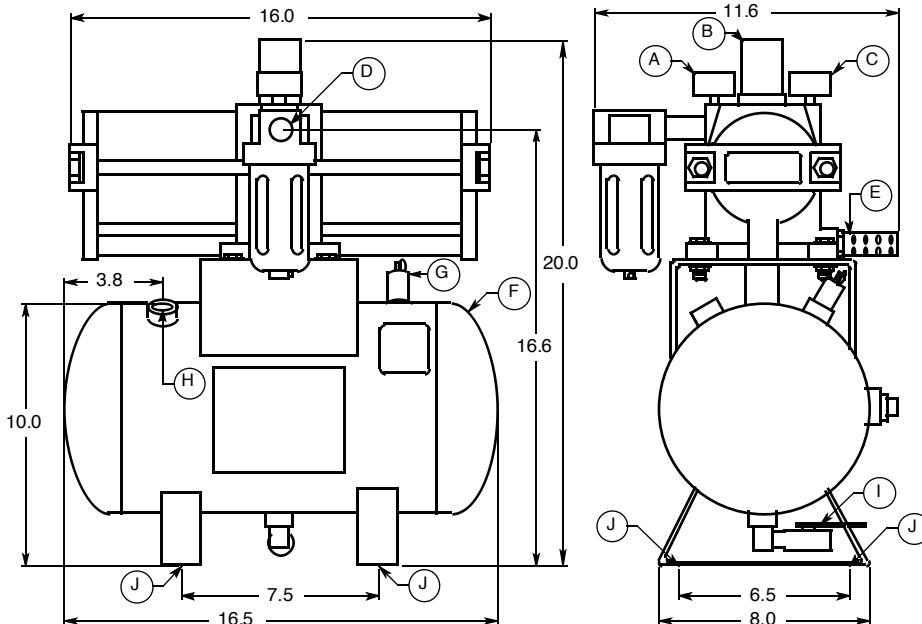

### MODEL CN001 FEATURES

- A. Inlet pressure gauge
- B. Built-in pressure regulator
- C. Discharge pressure gauge
- D. 1/2" FNPT inlet filter
- E. Exhaust silencer
- F. 3.5 gallon, 350psig ASME tank
- G. 250psig ASME safety valve
- H. 1/2" FNPT discharge port
- I. 1/4" FNPT condensate drain valve
- J. Four 1/2" diameter mounting holes

### MODEL CN001 SPECIFICATIONS

- Maximum 2 to 1 boost ratio
- Capable of 100% duty cycle
- Inlet pressure range of 15-150 psig
- Discharge pressure range of 15-230 psig
- Temperature range of 40-130°F
- Approximate weight of 45 pounds
- Integral regulator controls discharge pressure and is self-relieving

Dimensions are in inches. Dimensions, features and specifications shown in this brochure are subject to change without notice.



Midwest Pressure Systems, Inc.  
204 Easy Street  
Carol Stream, IL 60188

Phone 630-933-9037  
Fax 630-933-9040  
www.midwestpressuresystems.com



**Manufacturer of Air and Gas Pressure Booster Systems**